



# DANPAL<sup>®</sup> EVERBRIGHT

The Strong Unique  
Building Solution





Gage Roads Brew Company | Architect: Finespun

**UNLEASH LARGE-SPAN DESIGNS  
WITH THE EVERBRIGHT SYSTEM**



## **SLEEK DESIGN DELIVERING WIDE OPEN VIEWS**

Design bolder entry, walkway, and plaza canopies with the Everbright Canopy. A self-supporting, clear or translucent solution that pairs long, clean spans with soft diffused daylight and outstanding durability. Everbright helps you deliver luminous cover without heavy secondary structure or visual clutter.

Everbright is a dry-glazed, 3" inch thick modular canopy system for straight or curved applications. Panels deliver naturally light, full UV protection with excellent thermal and fire performance. All in a system that's engineered for quick, clean installation on projects where longevity and visual clarity matter.

Our Lady of the Rosary Primary School, Australia  
Architect: Alleanza

\*Contact Danpal Technical Services for project specific span information



# THE STRONGEST TRANSLUCENT SYSTEM IN THE WORLD!

## SYSTEM BENEFITS

- Easy Dry-glazed Installation
- Waterproof
- Straight and Curved
- Roofs and Canopies
- Large Free Spans
- 4x3 inch Modular Tubes
- UV Protection
- Excellent Fire Performance
- High Insulation

Byford Secondary College, Western Australia  
Architect: Donaldson & Warn

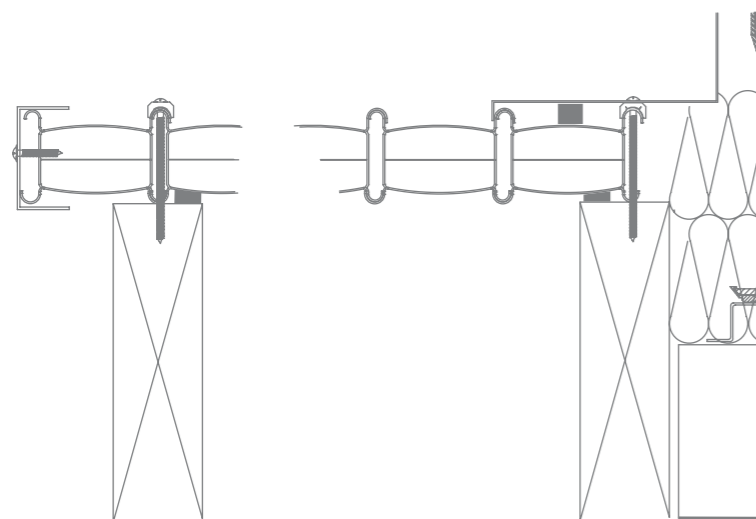

Roof edge details

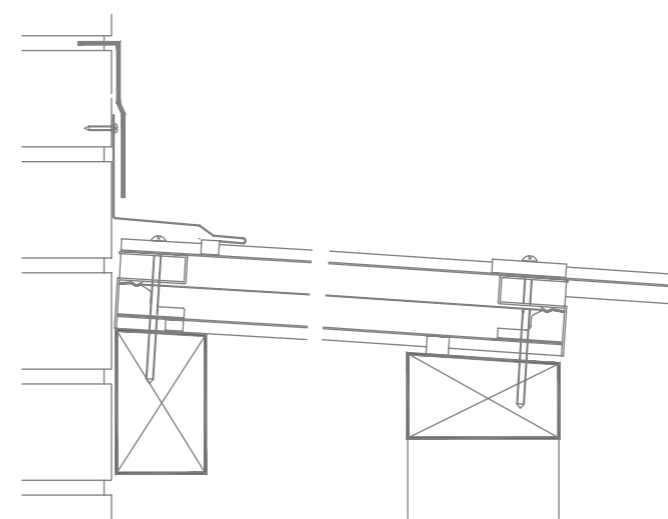

Roof wall and fascia details



McAuley Community School  
Architect: Swanbury Penglese

## OPTICAL AND SOLAR PROPERTIES

	LT%	ST%	SR%	SHGC
Clear	73*	51	40	0.53
Blue	59*	49	32	0.53

\* 10% less when using 1 cell of Nanogel. 20% less when using 2 cells of Nanogel.

\* Danpal is engaged in constant innovation. We reserve the right to modify our products, specifications and test data. Contact Danpal Technical Support for the most up to date information.

## TECHNICAL FEATURES

U-value BTU/hr*ft² F)	0.33
Fire classification	ISO 9705 Group 2 result
Minimum slope	5 degrees
Manufactured according to certification	ISO 9001 ISO 14001
Impact resistance	AS1562-3



Coles Shopping Village Huntlee, Australia  
Architect: EJE Architecture



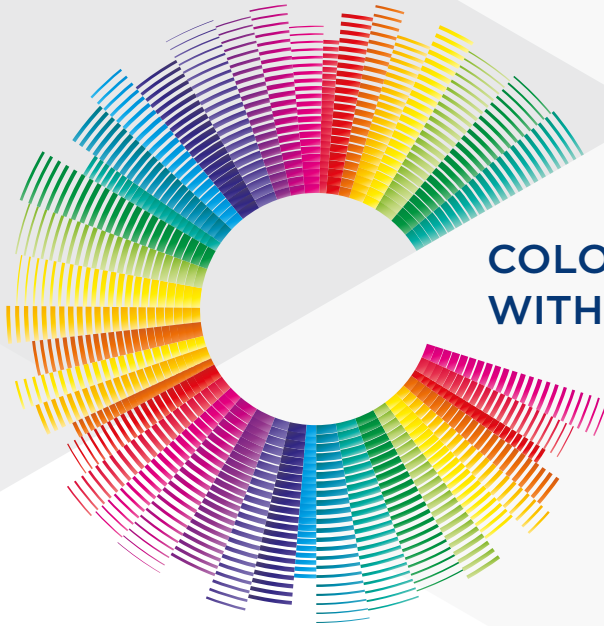

## COLOR YOUR ATMOSPHERE WITH THE DANPAL® PALETTE

### ABOUT THE COMPANY

#### Innovative light architecture systems for building envelopes

Danpal® are creators of exceptional light-transmitting architectural systems for building envelopes, providing optimal solar and thermal comfort.

For 50 years, our innovative systems have helped architects to transform light (both natural and artificial) into a powerful and versatile tool, for architectural creations that are internally and externally radiant.

An industry visionary, Danpal® are originators of the Danpalon® translucent panel standing seam system - a light architecture solution used around the world in commercial, education, transport, health, sports and high-tech projects.

Today, the company offers complete systems - providing total solutions for the building envelope. Danpal® designs, manufactures and distributes an unmatched range of daylighting systems for all types of building requirements - from facades, cladding, roofs, skylights, shading, to interior and outdoor applications.

Danpal® systems are built around innovative technologies, deep architectural know-how and the ever evolving needs of our clients. Operating in five continents, Danpal® inspires architectural creativity with its rainbow of light architecture solutions.

#### Danpal® Everbright is an integral part of Danpal's range of systems - giving you a complete solution



FAÇADE



CLADDING



SKYLIGHT



OUTDOOR



SHADING



INTERIOR

[www.danpal.com](http://www.danpal.com)

Danpal North America | 3959 Bur Wood Drive, Suite 400 Waukegan IL 60085 | 312-724-8166

